

北面

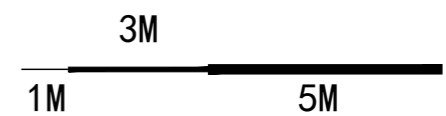

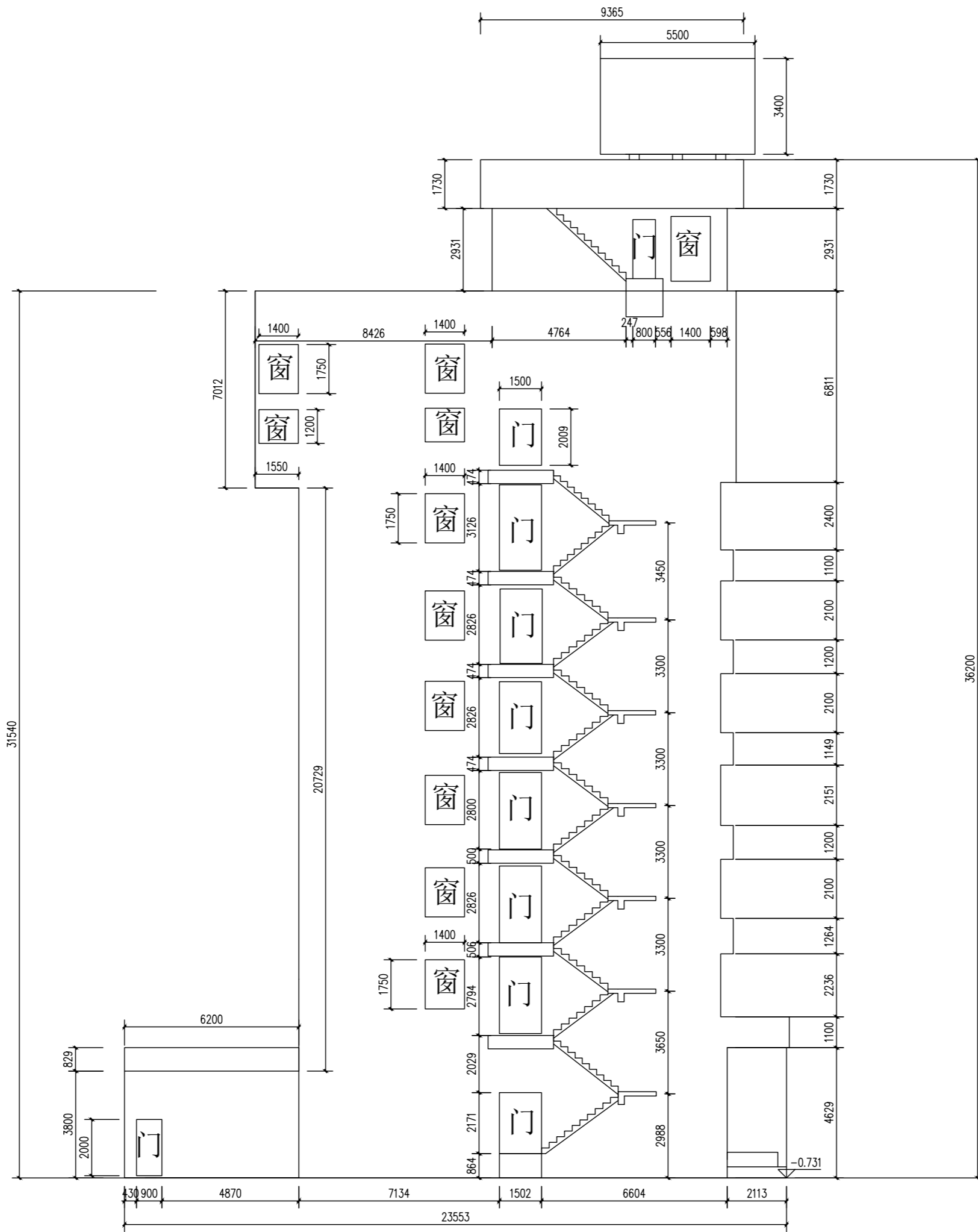

东面

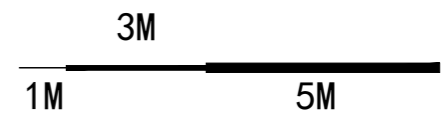

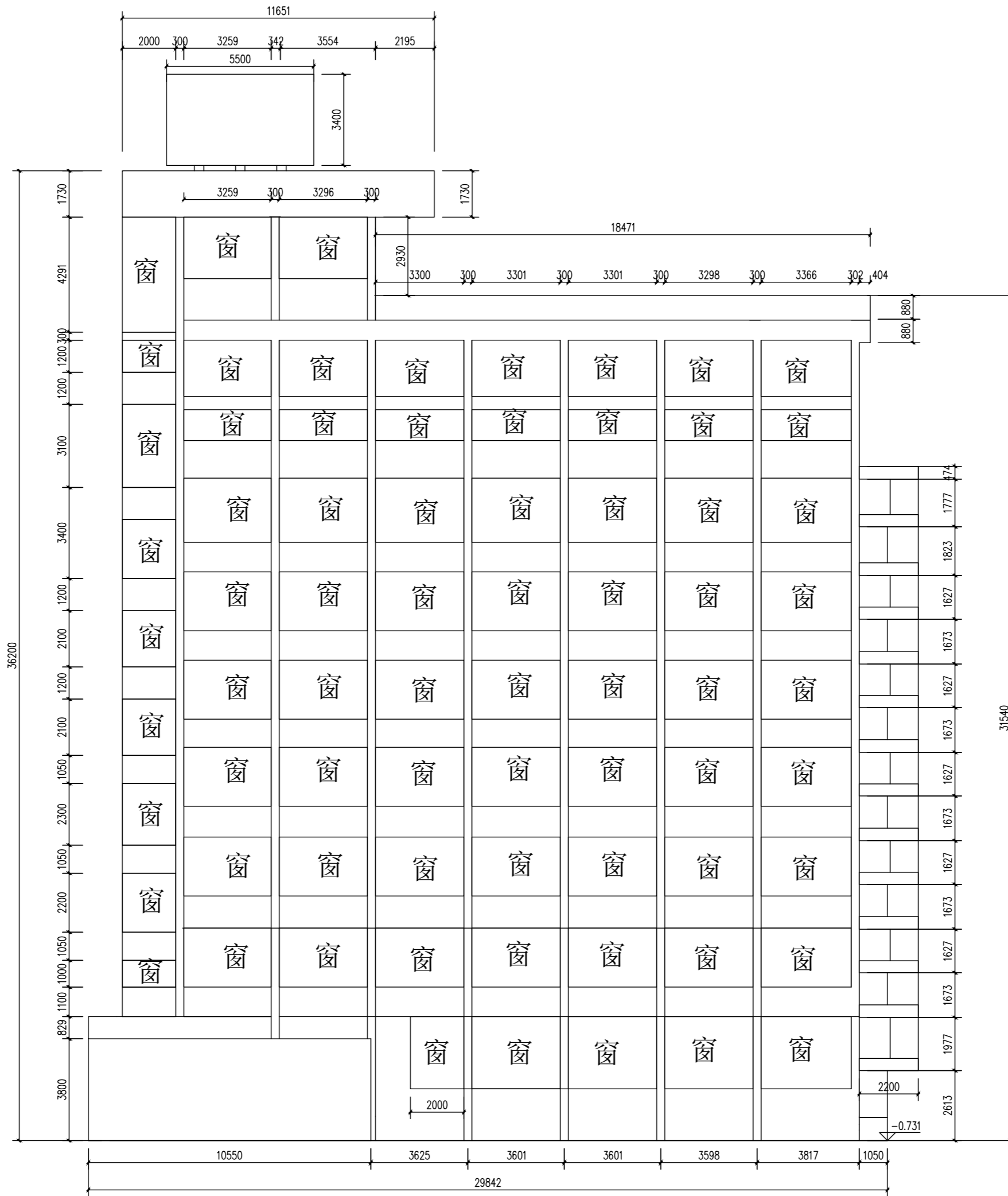

南面

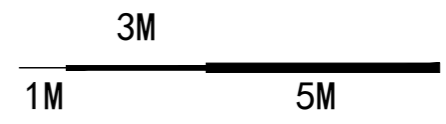

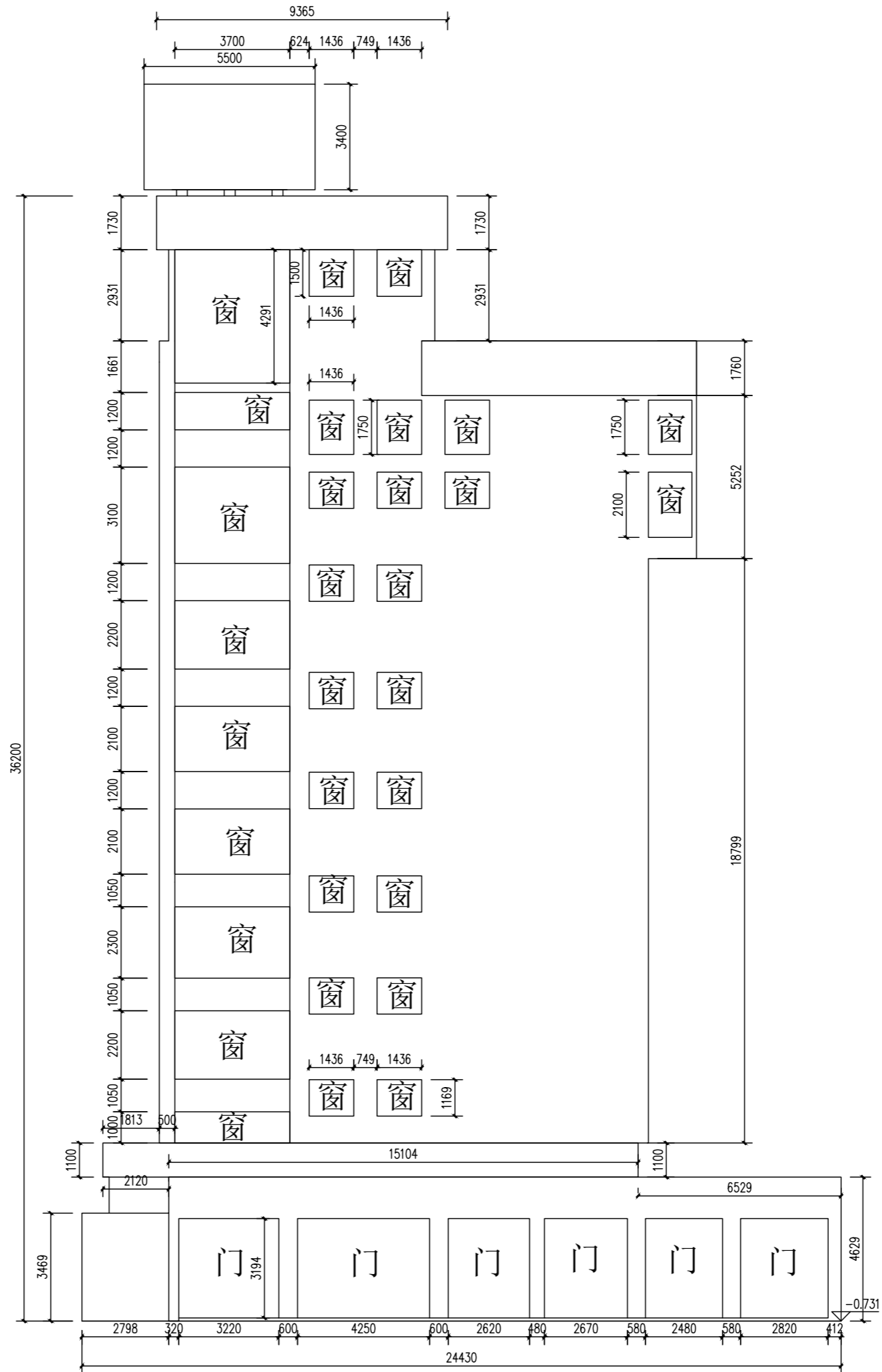

西面

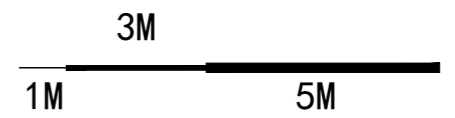

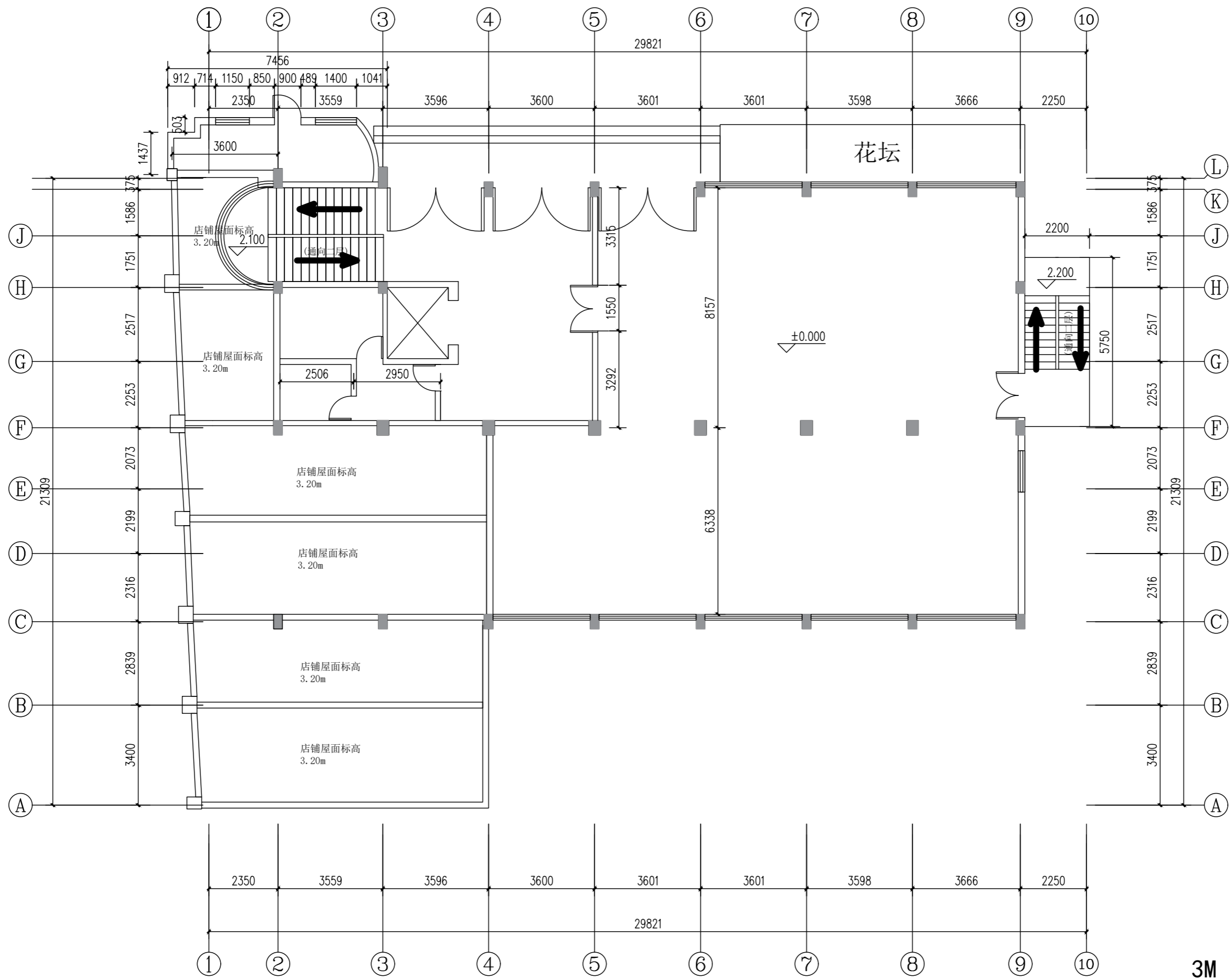

1层 (层高4.10m, 楼板厚0.10m)
 (标高以北侧一层大门为±0.00)

(北侧围墙)

6450

花坛

1890

店铺屋面标高
3.20m

店铺屋面标高
3.20m

店铺屋面标高
3.20m

店铺屋面标高
3.20m

店铺屋面标高
3.20m

店铺屋面标高
3.20m

4340

(东侧建筑)

(西侧道路)

2060

6080

(南侧围墙)

3M

1M

5M

1层

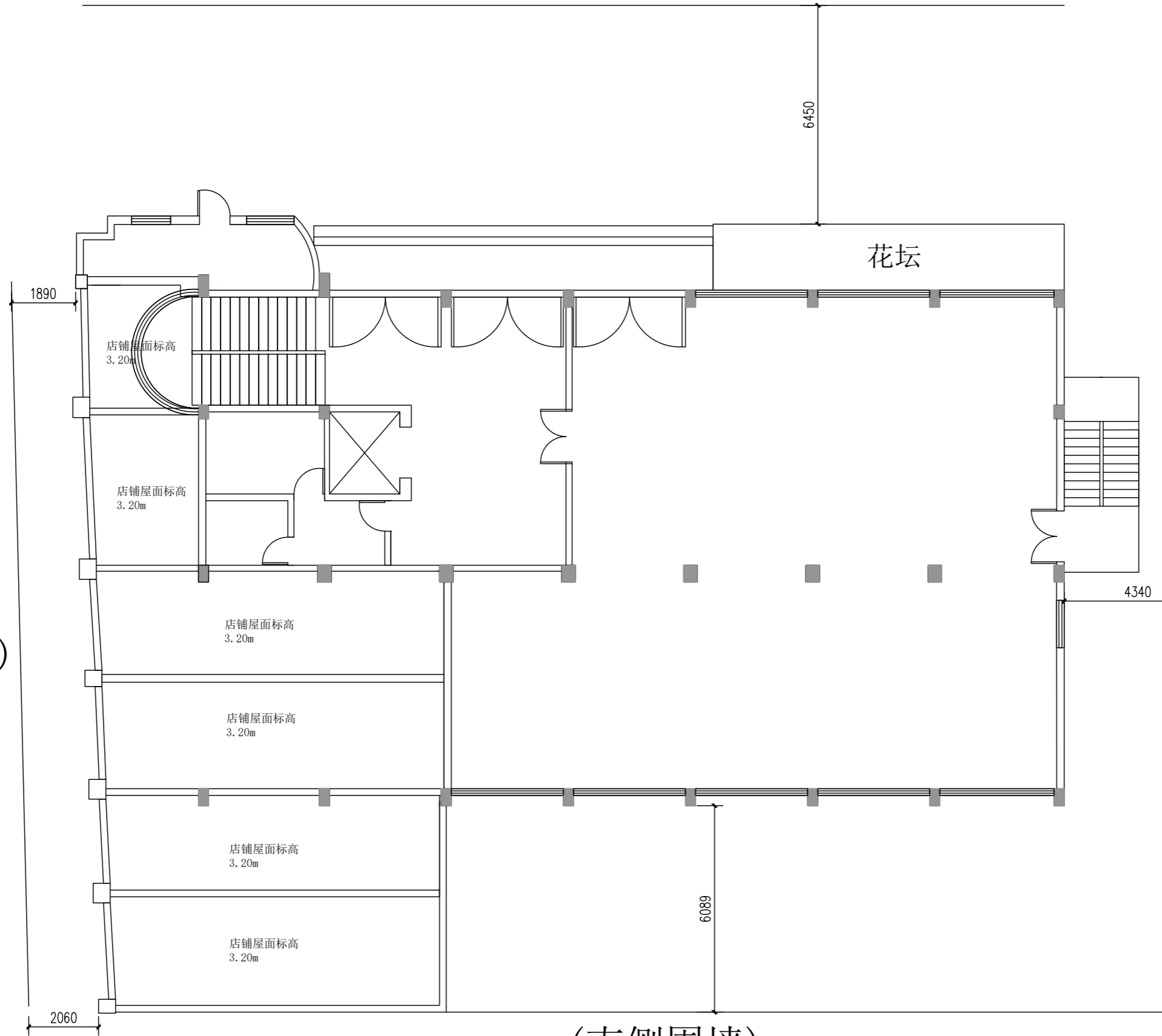

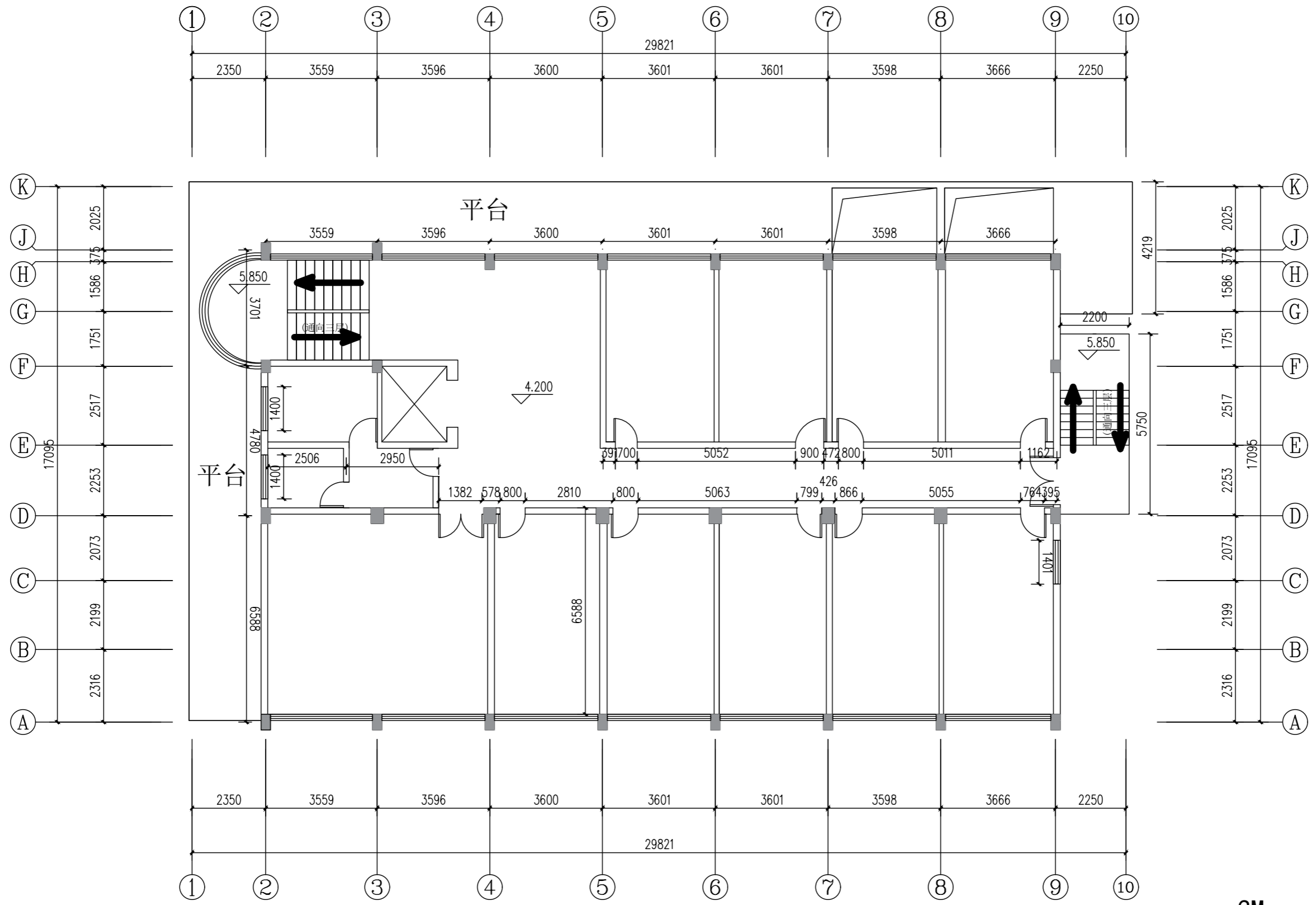

2层 (层高3.20m, 楼板厚0.10m)

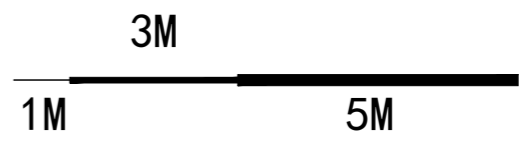

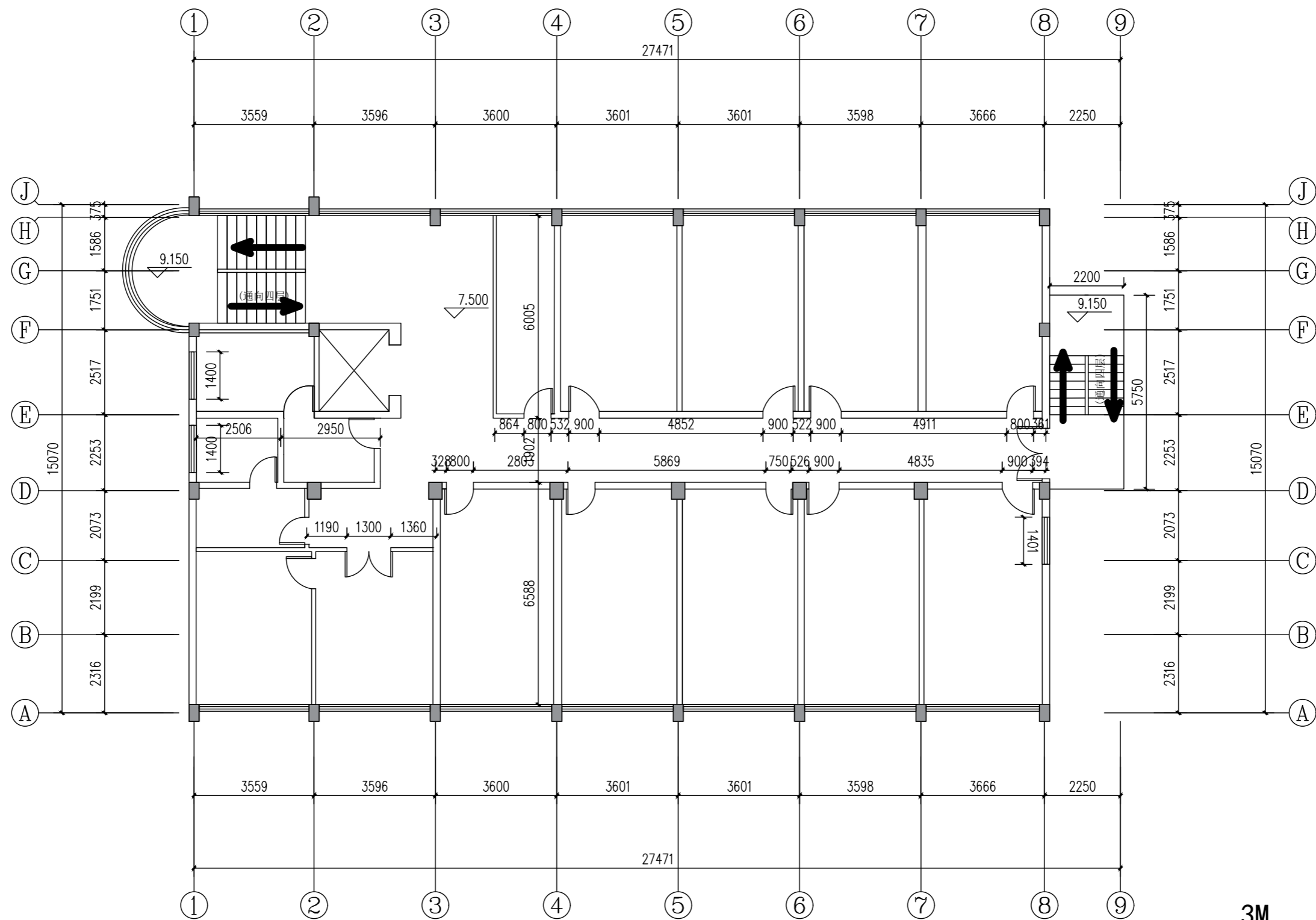

3层 (层高3.20m, 楼板厚0.10m)

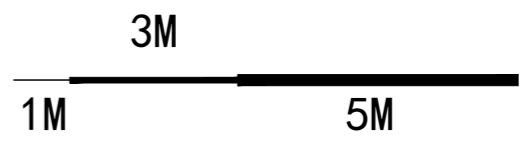

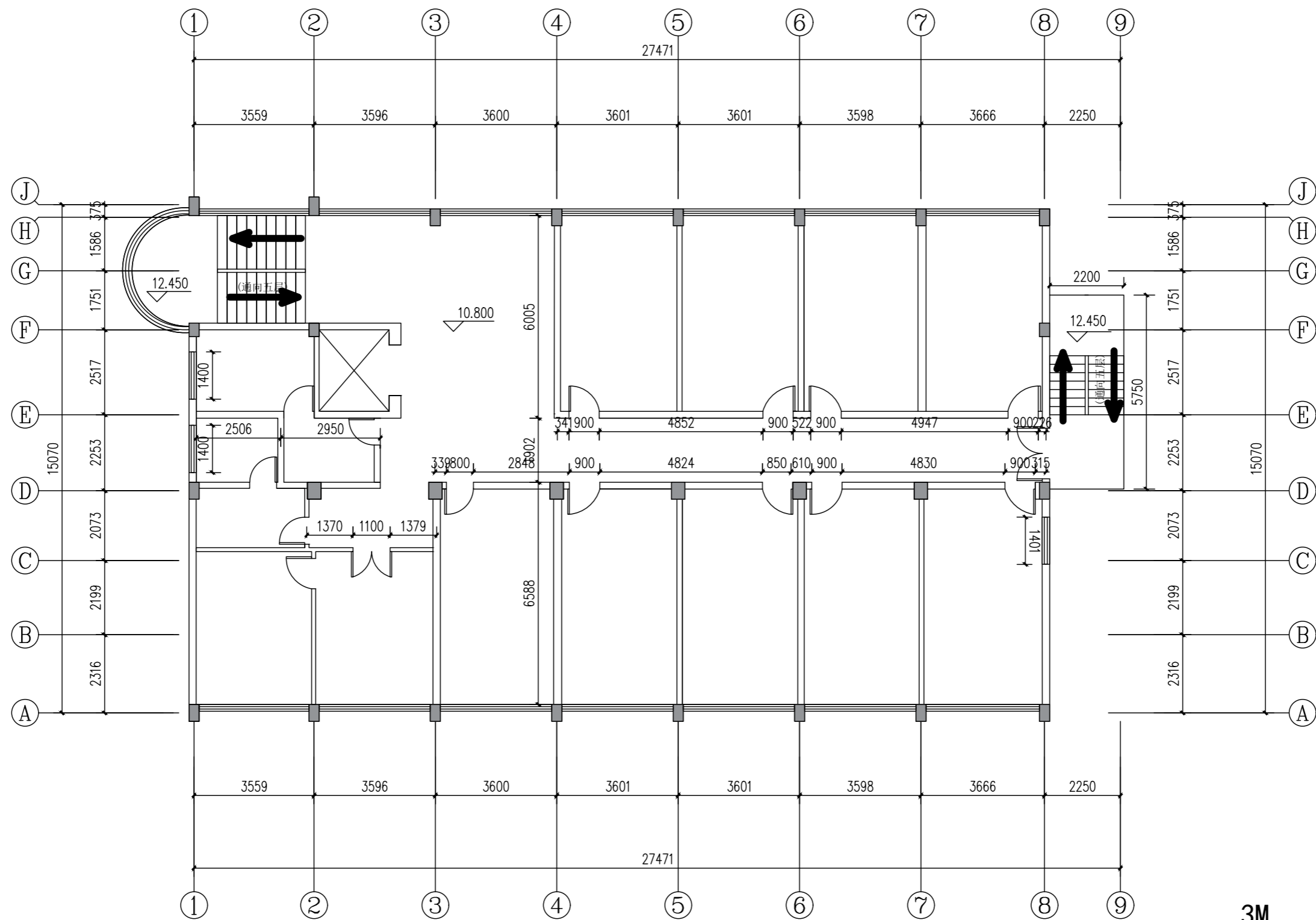

4层 (层高3.20m, 楼板厚0.10m)

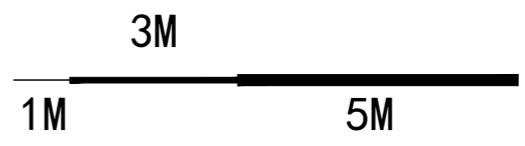

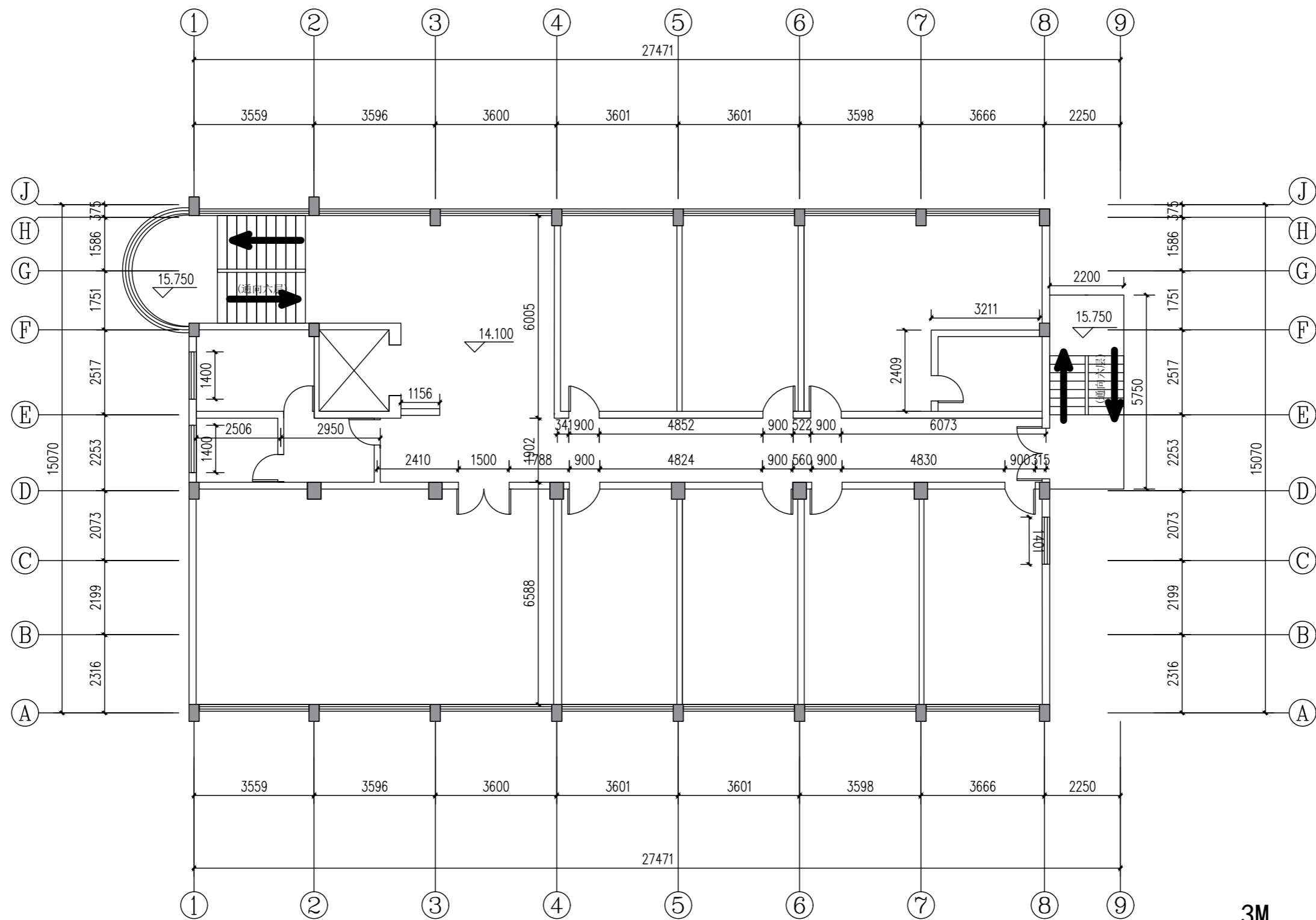

5层 (层高3.20m, 楼板厚0.10m)

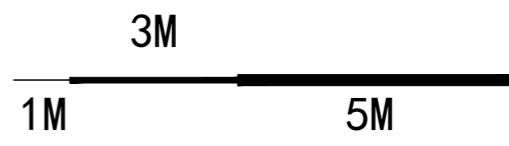

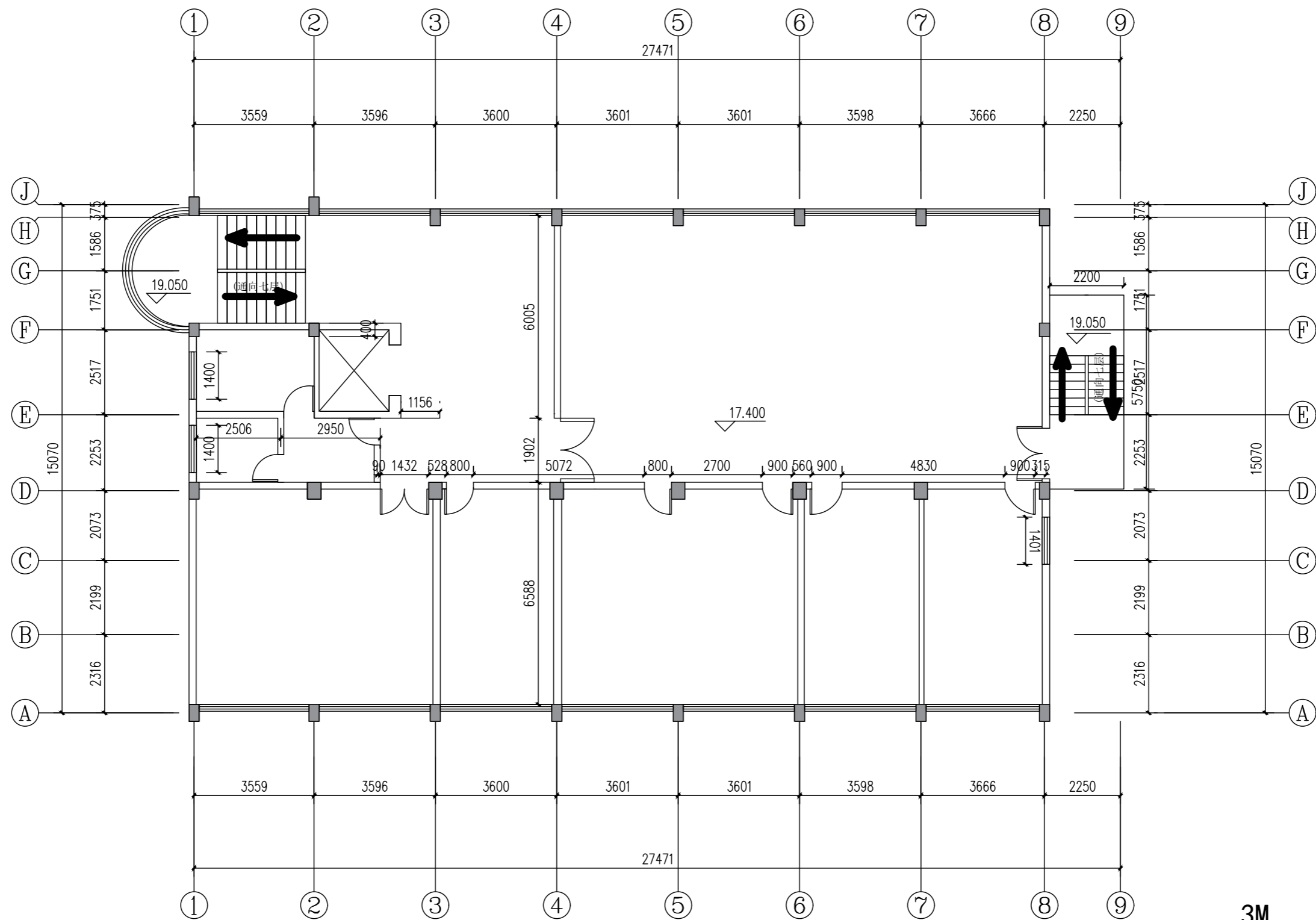

6层 (层高3.20m, 楼板厚0.10m)

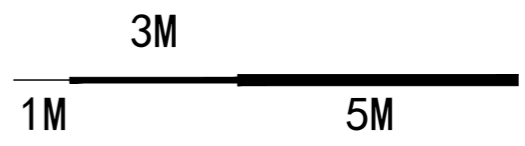

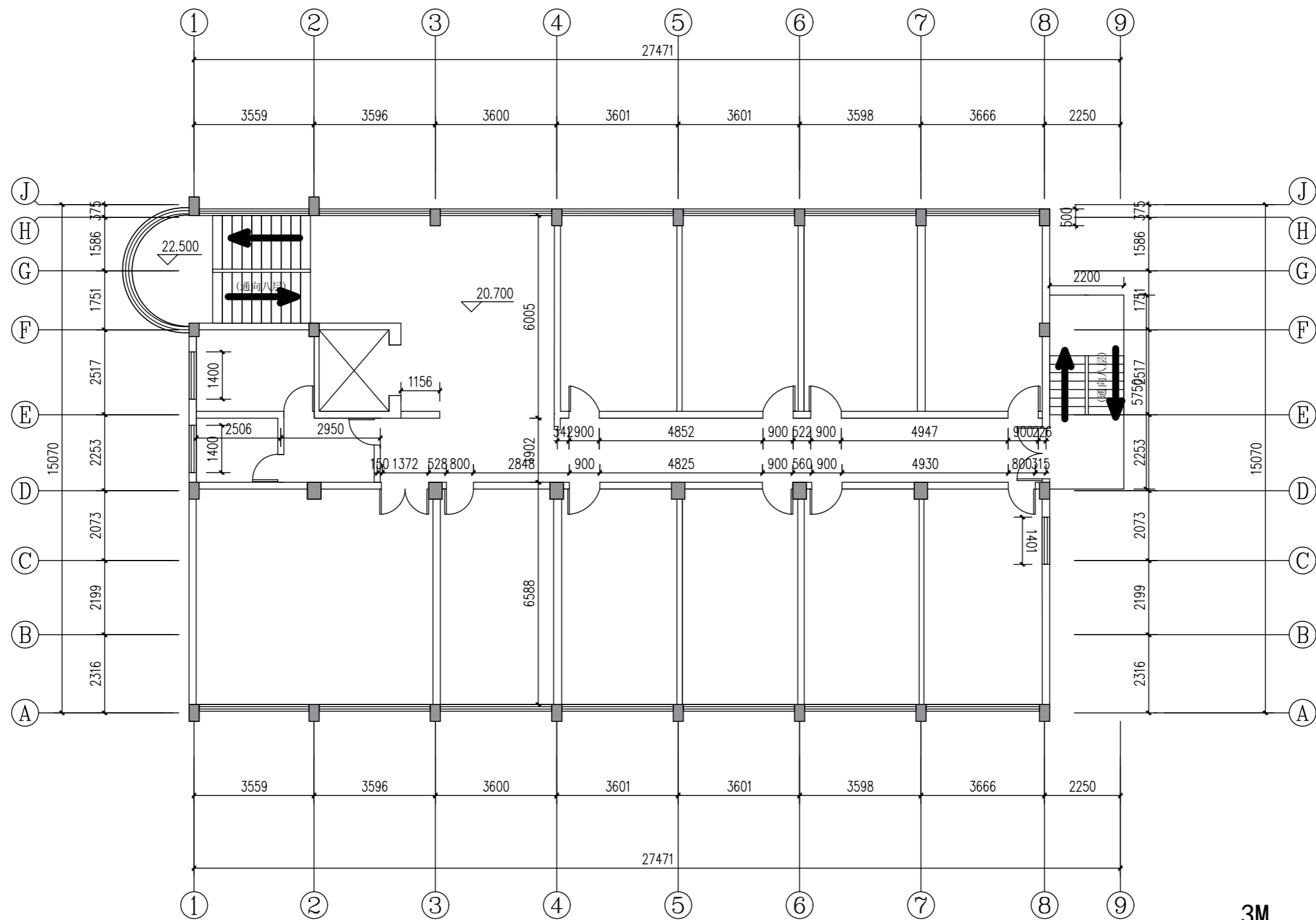

7层 (层高3.50m, 楼板厚0.10m)

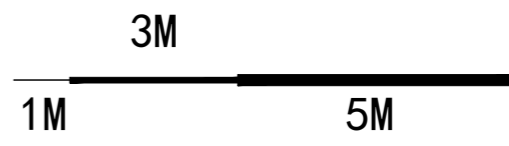

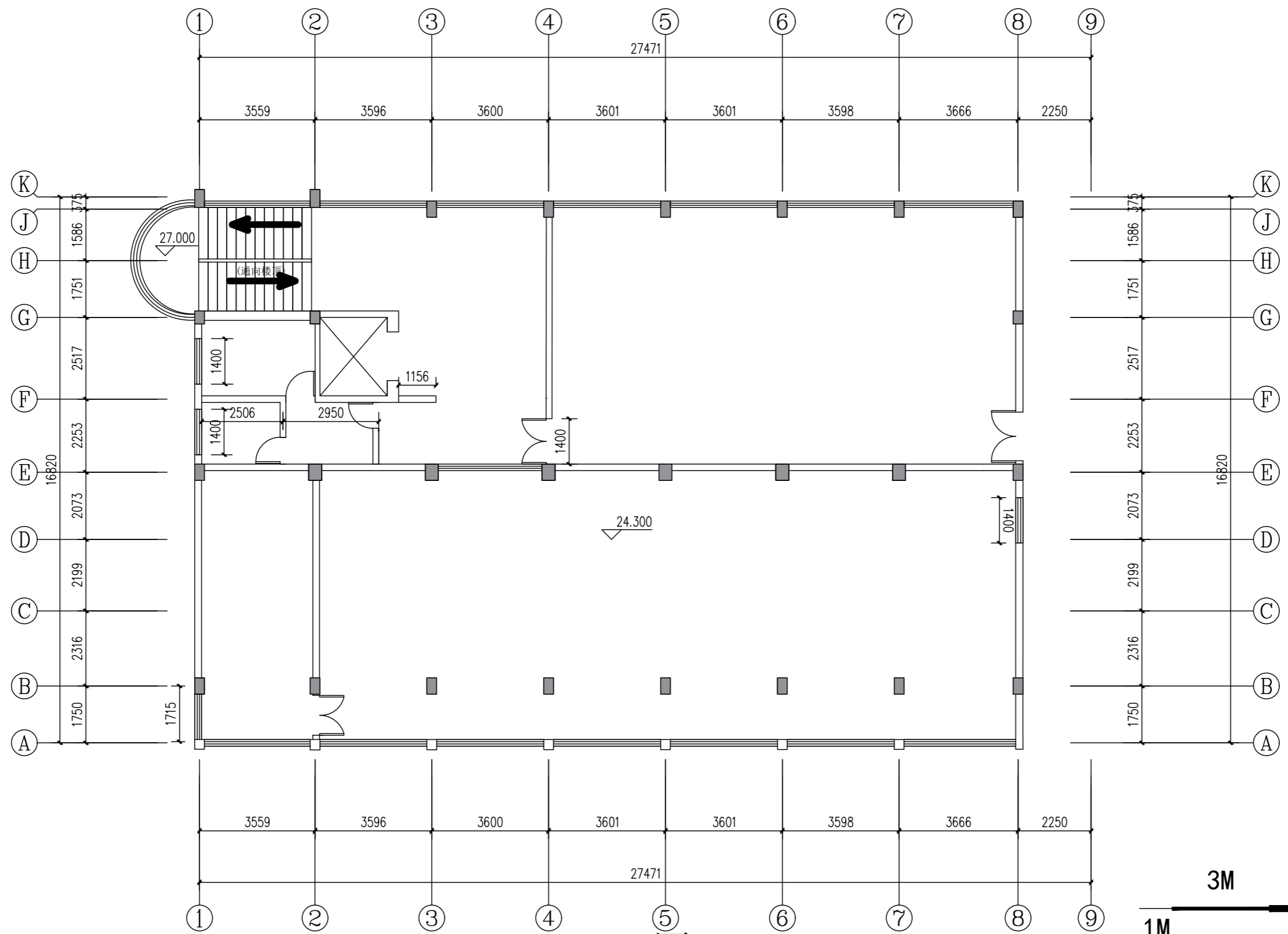

8层 (层高5.10m, 楼板厚0.10m)

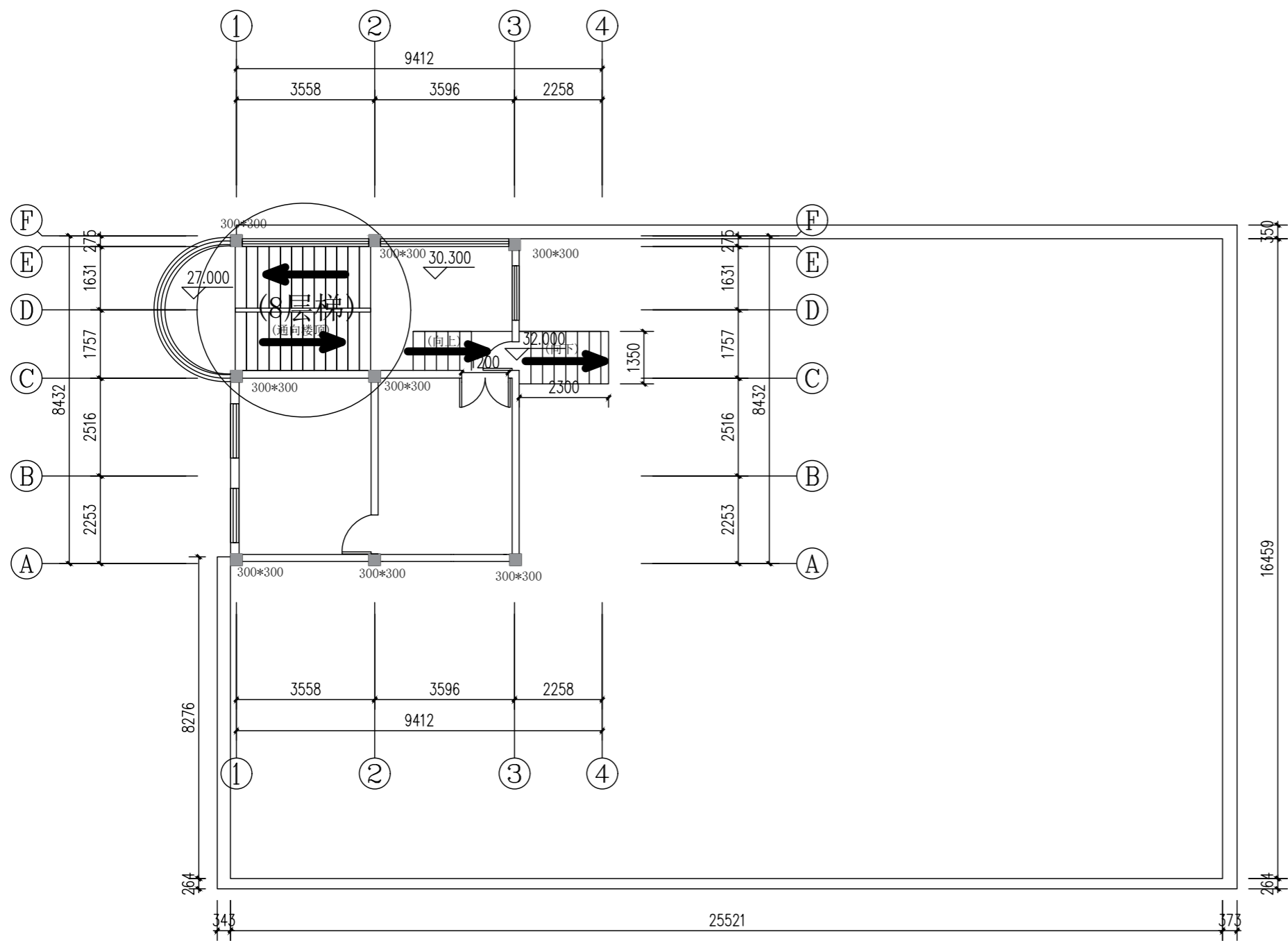

楼顶 (层高3.70m, 楼板厚0.10m)

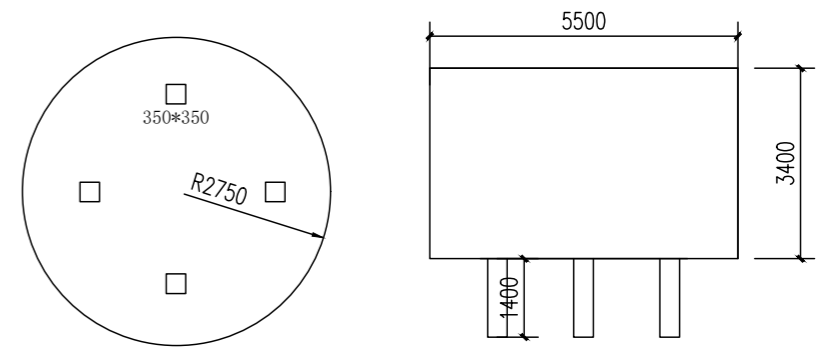

楼顶水塔

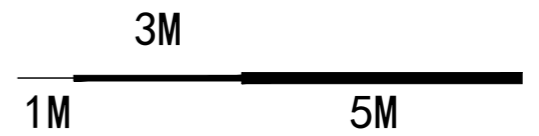

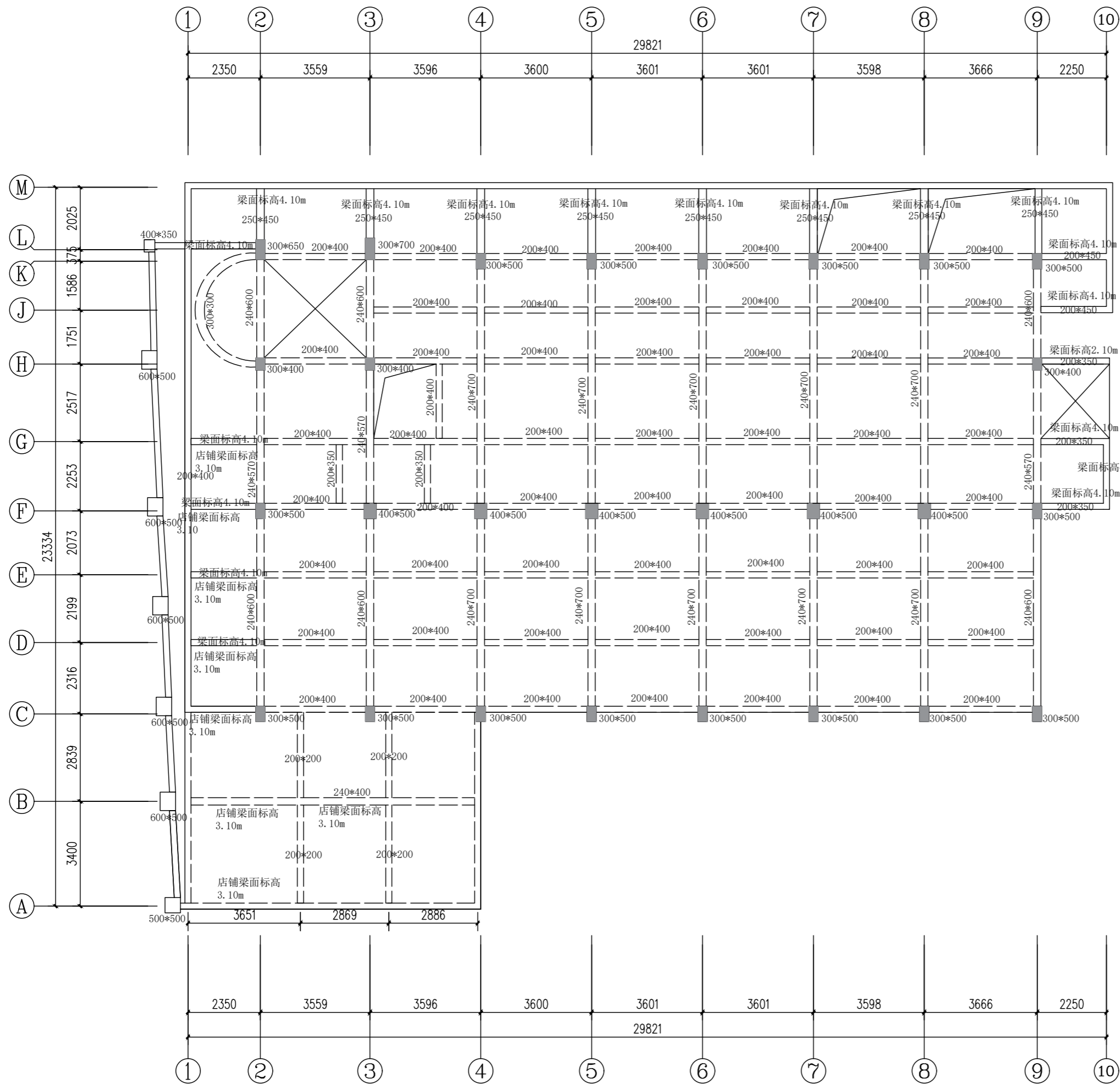

2层梁 (1层顶) (层高4.10m, 楼板厚0.10m)
 (标高以北侧一层大门为±0.00)

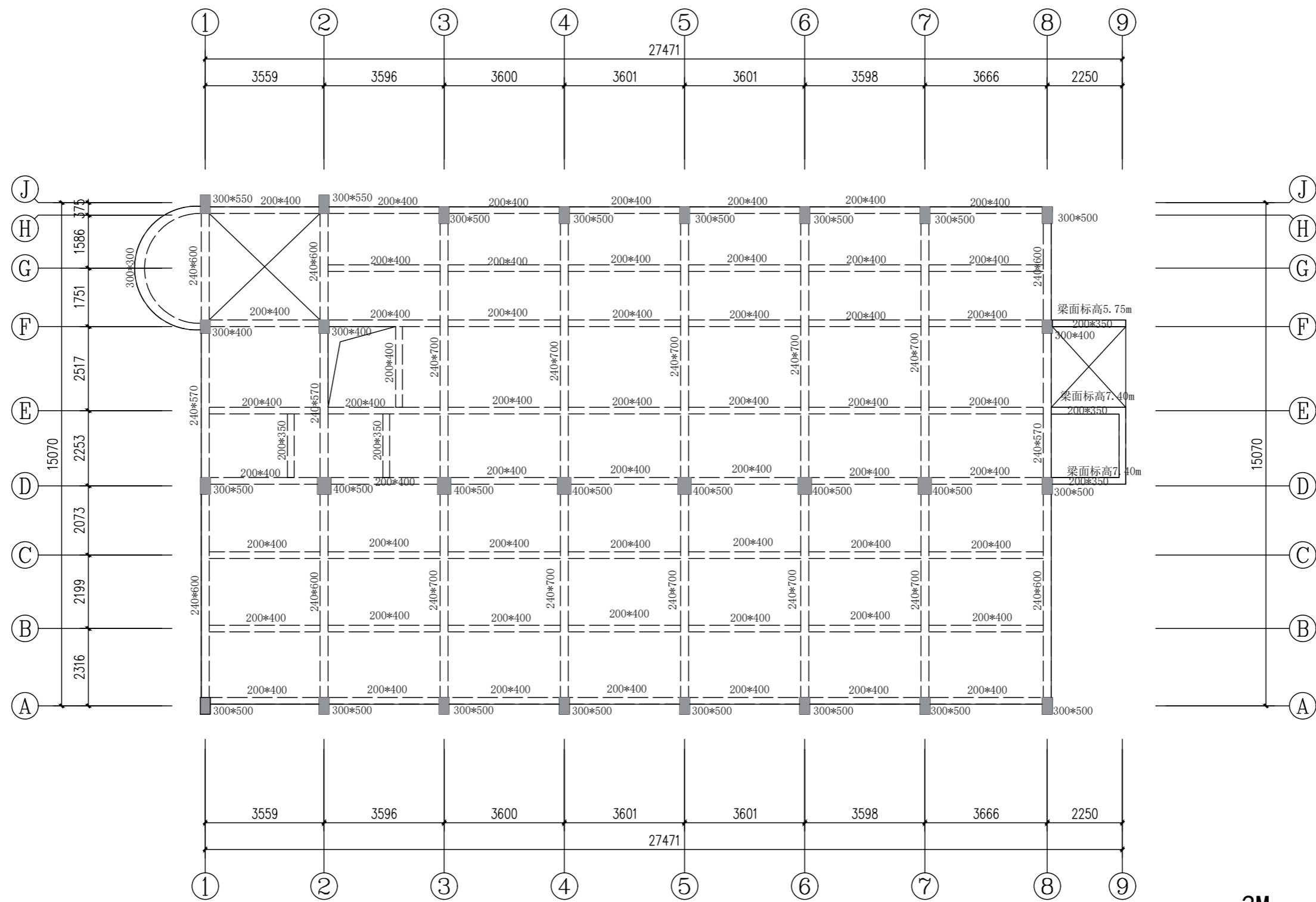

2层 (层高3.20m, 楼板厚0.10m)

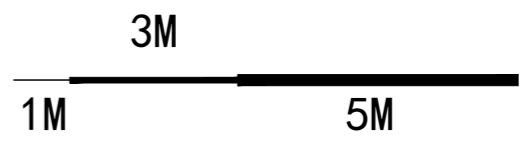

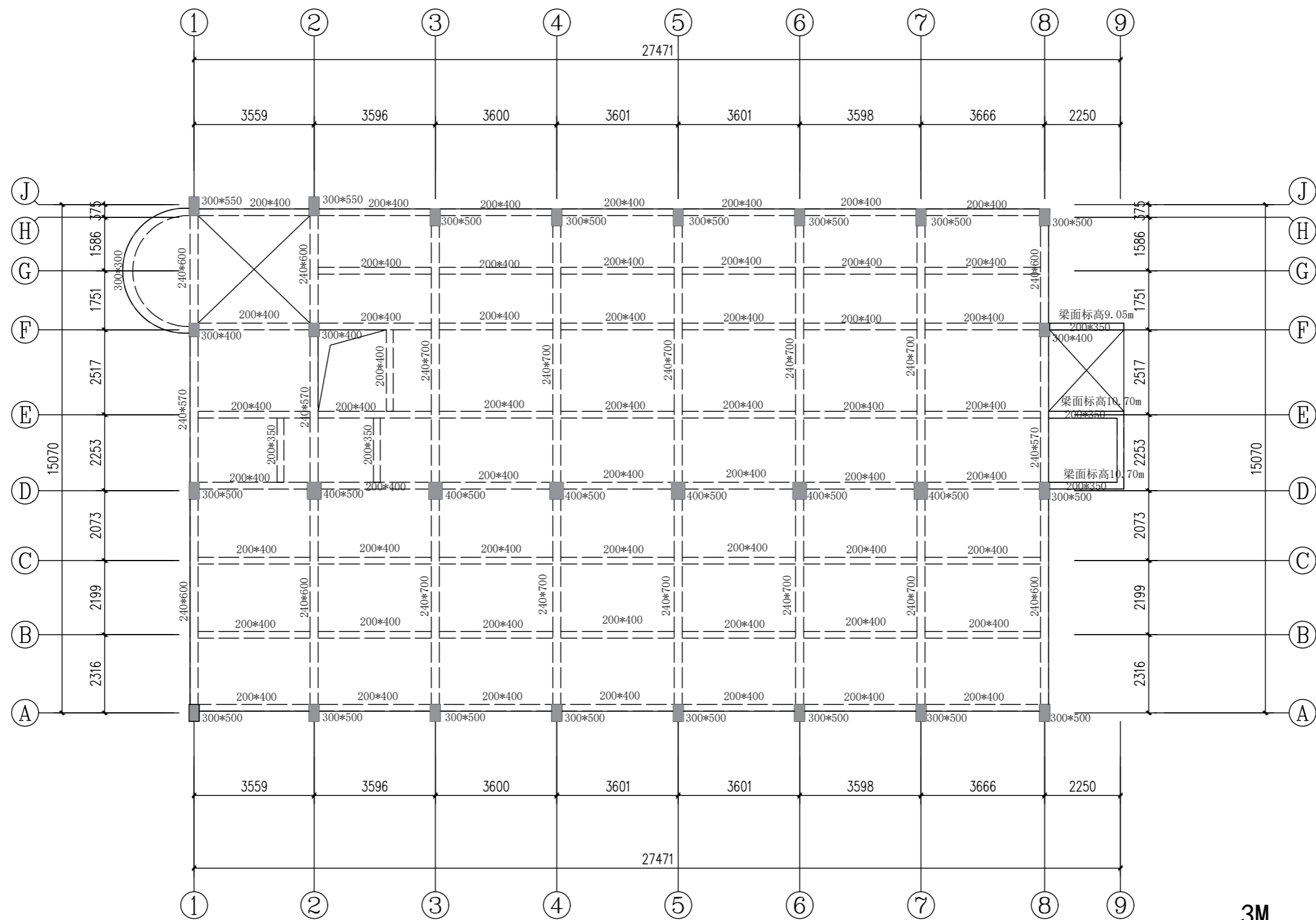

3层 (3层高3.20m, 楼板厚0.10m)

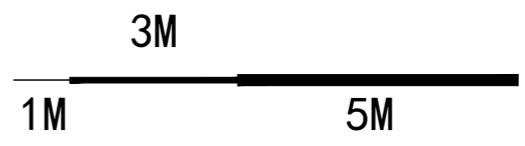

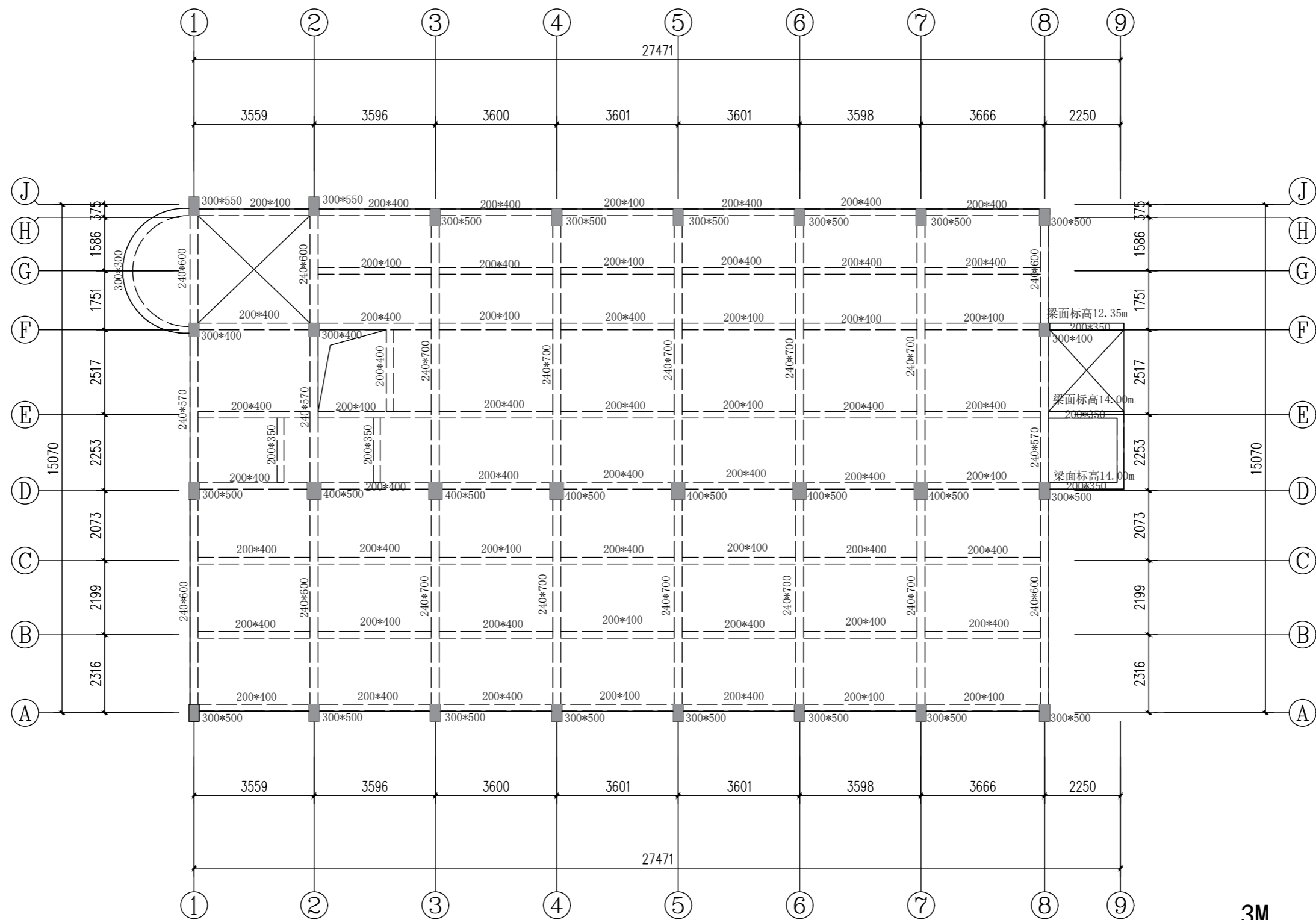

4层 (4层高3.20m, 楼板厚0.10m)

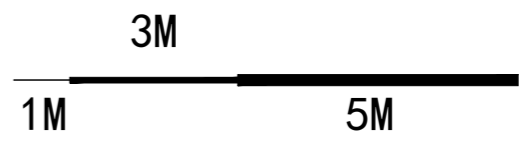

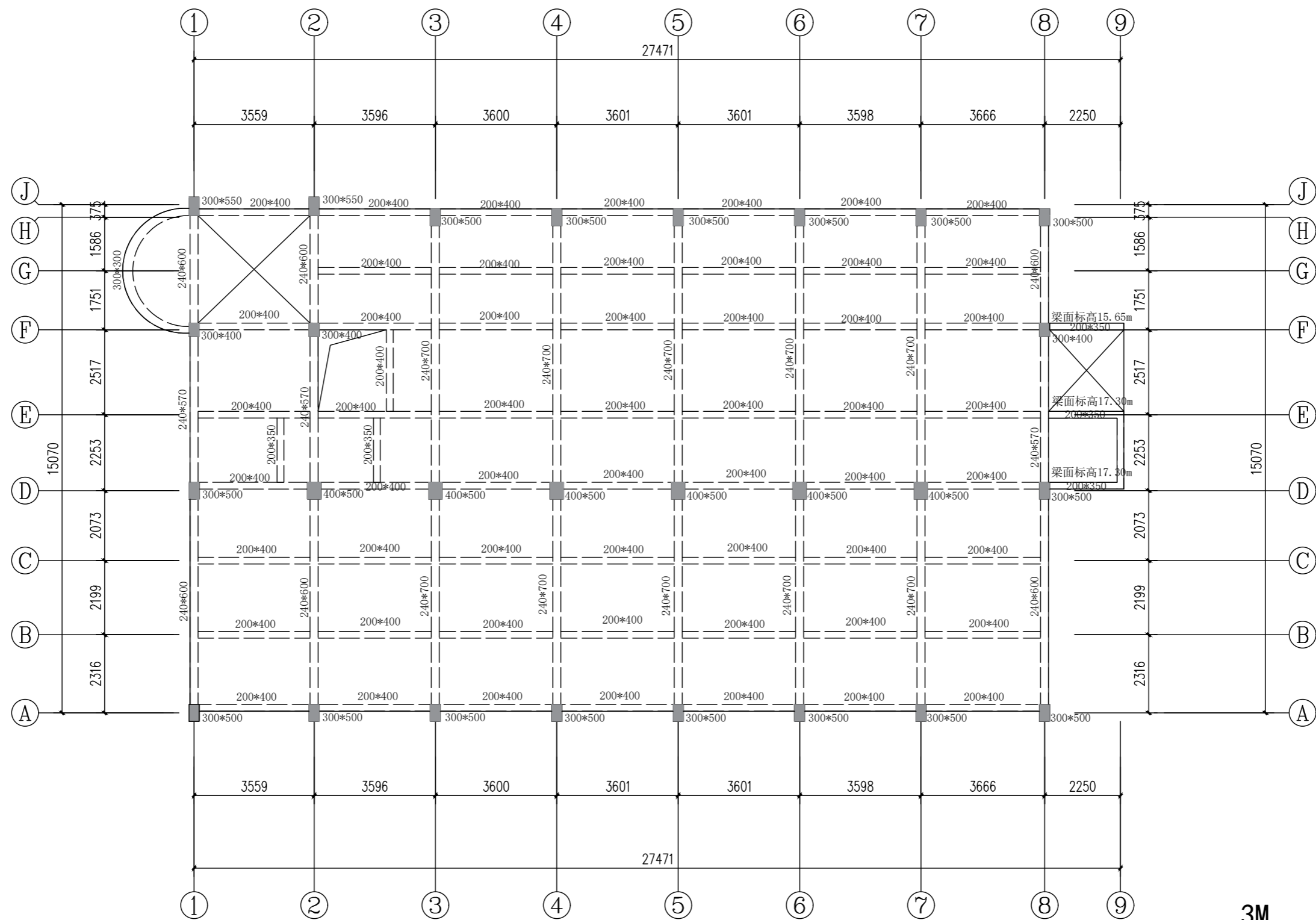

5层 (5层高3.20m, 楼板厚0.10m)

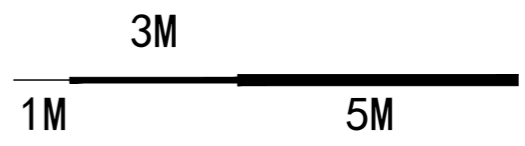

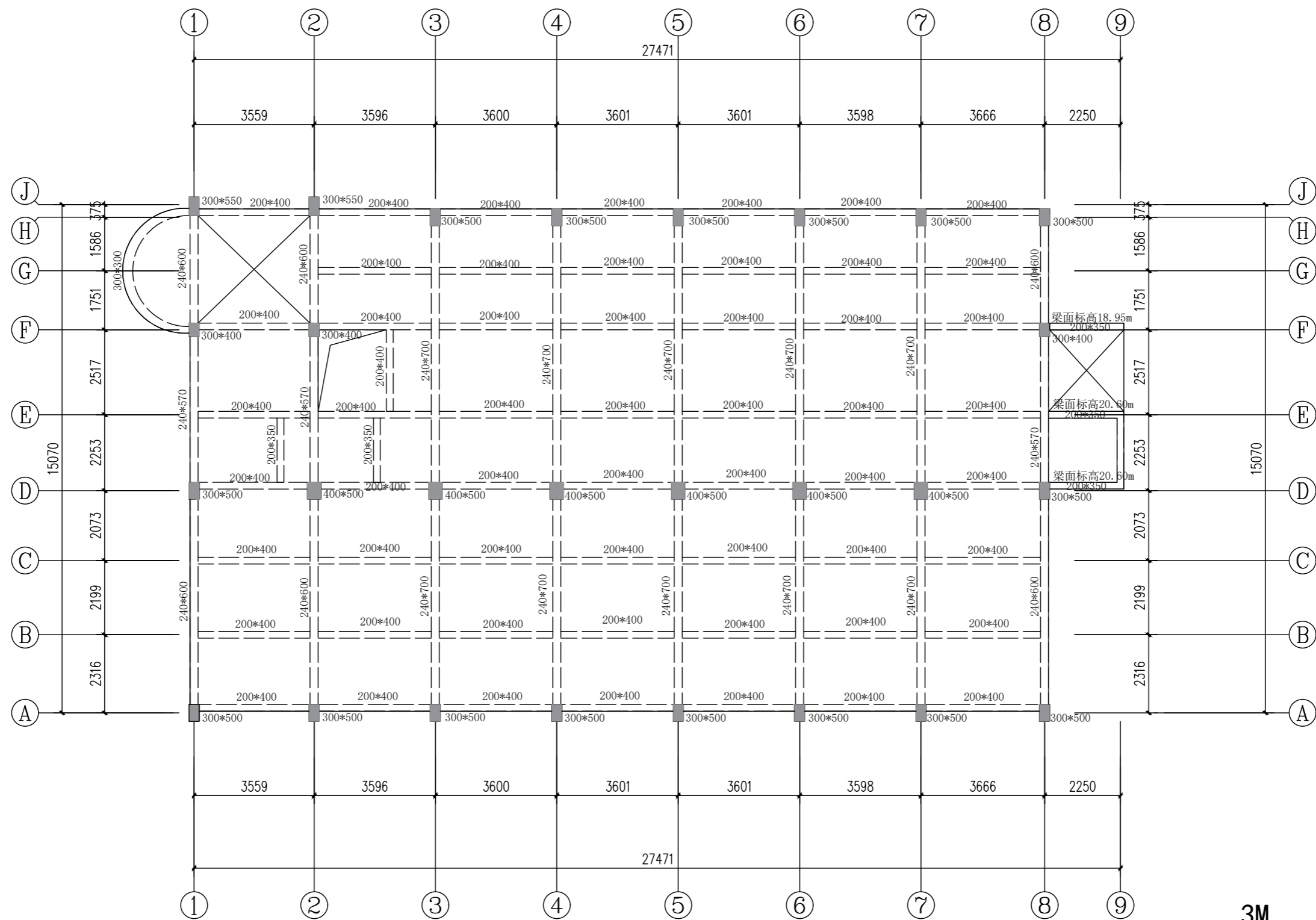

6层 (6层高3.20m, 楼板厚0.10m)

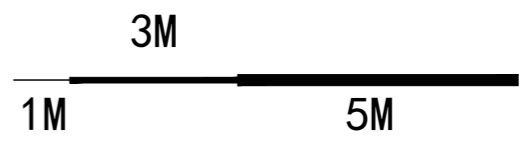

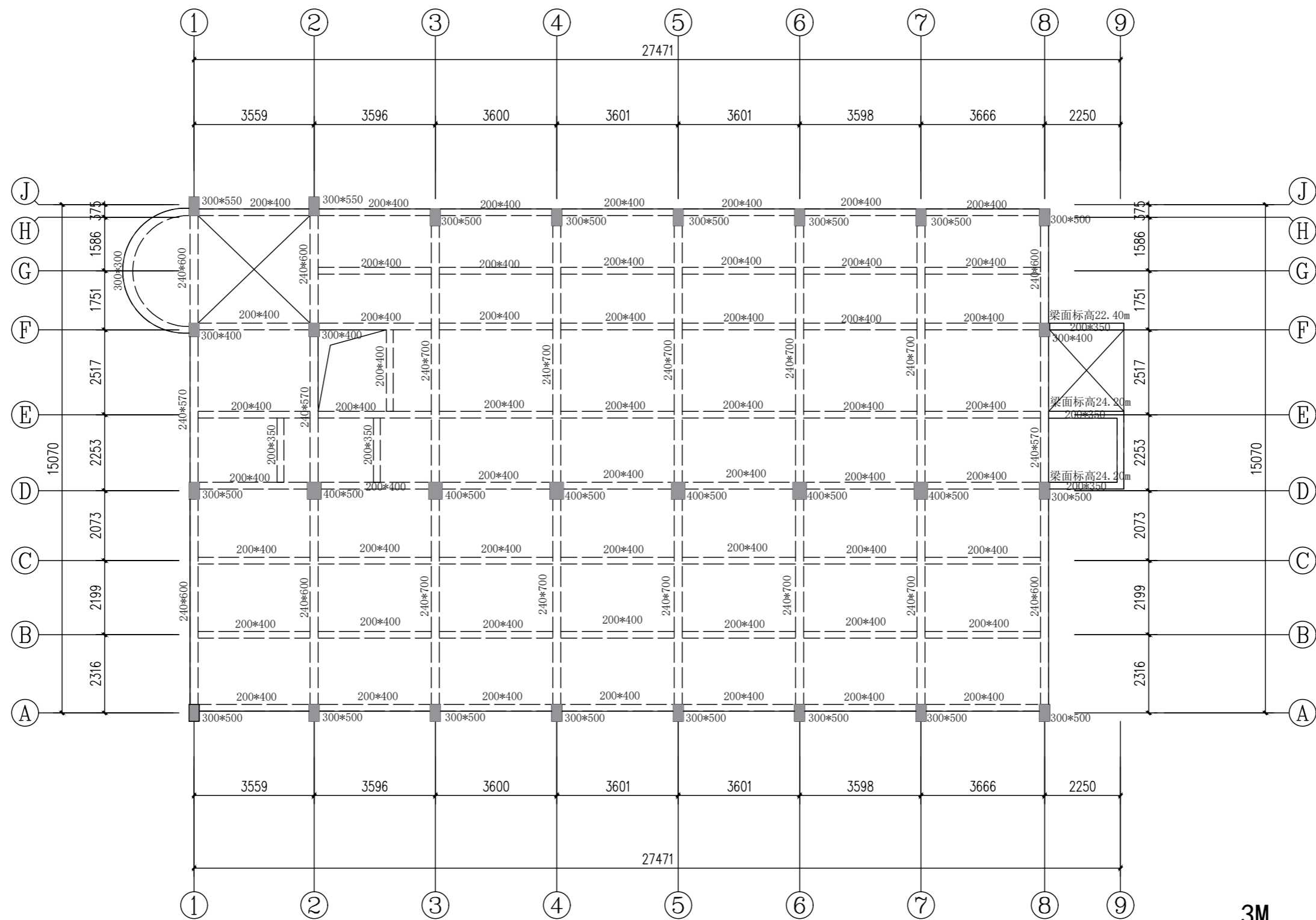

7层 (7层高3.50m, 楼板厚0.10m)

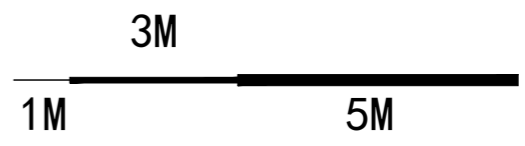

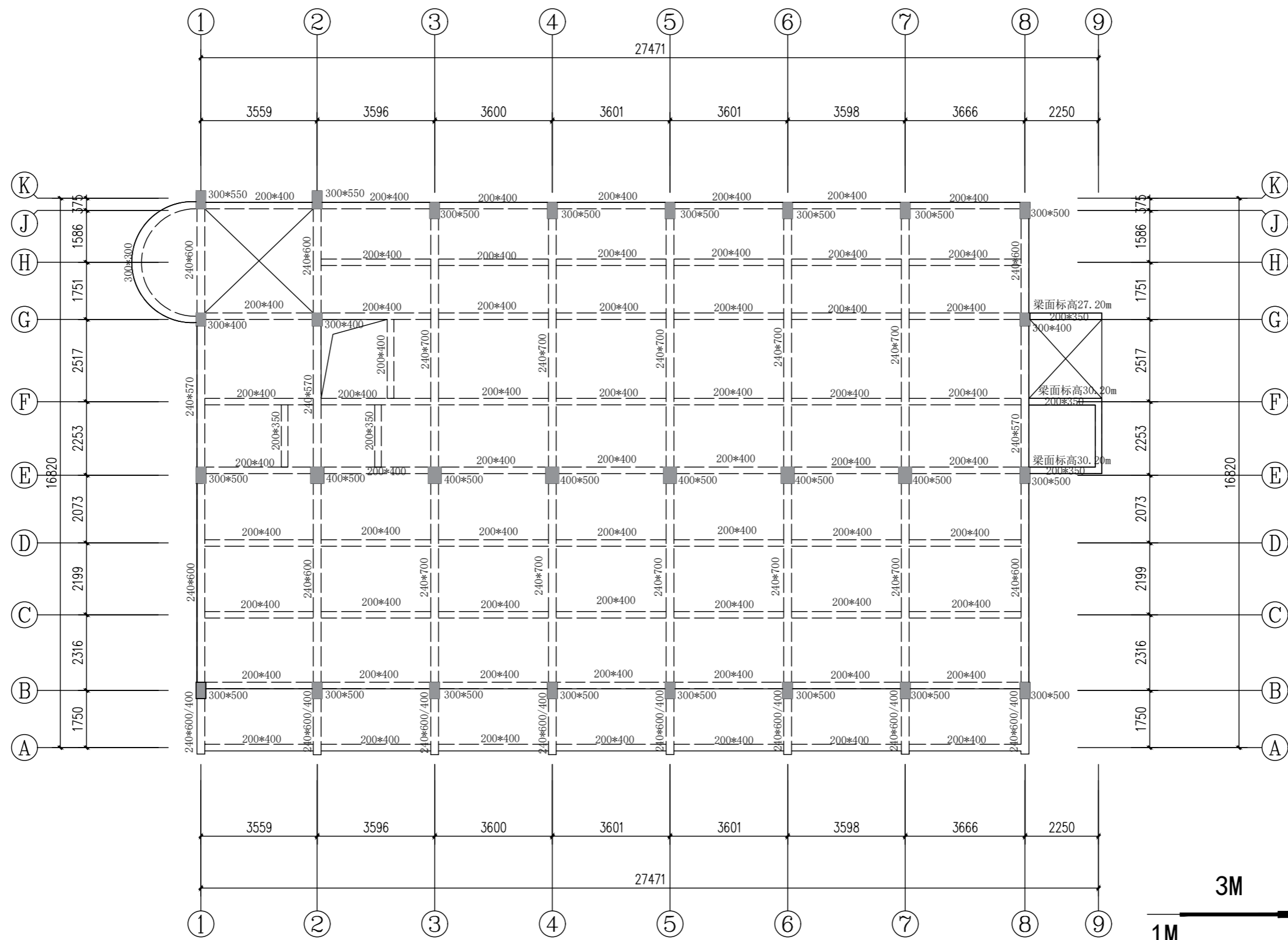

8层 (层高5.10m, 楼板厚0.10m)

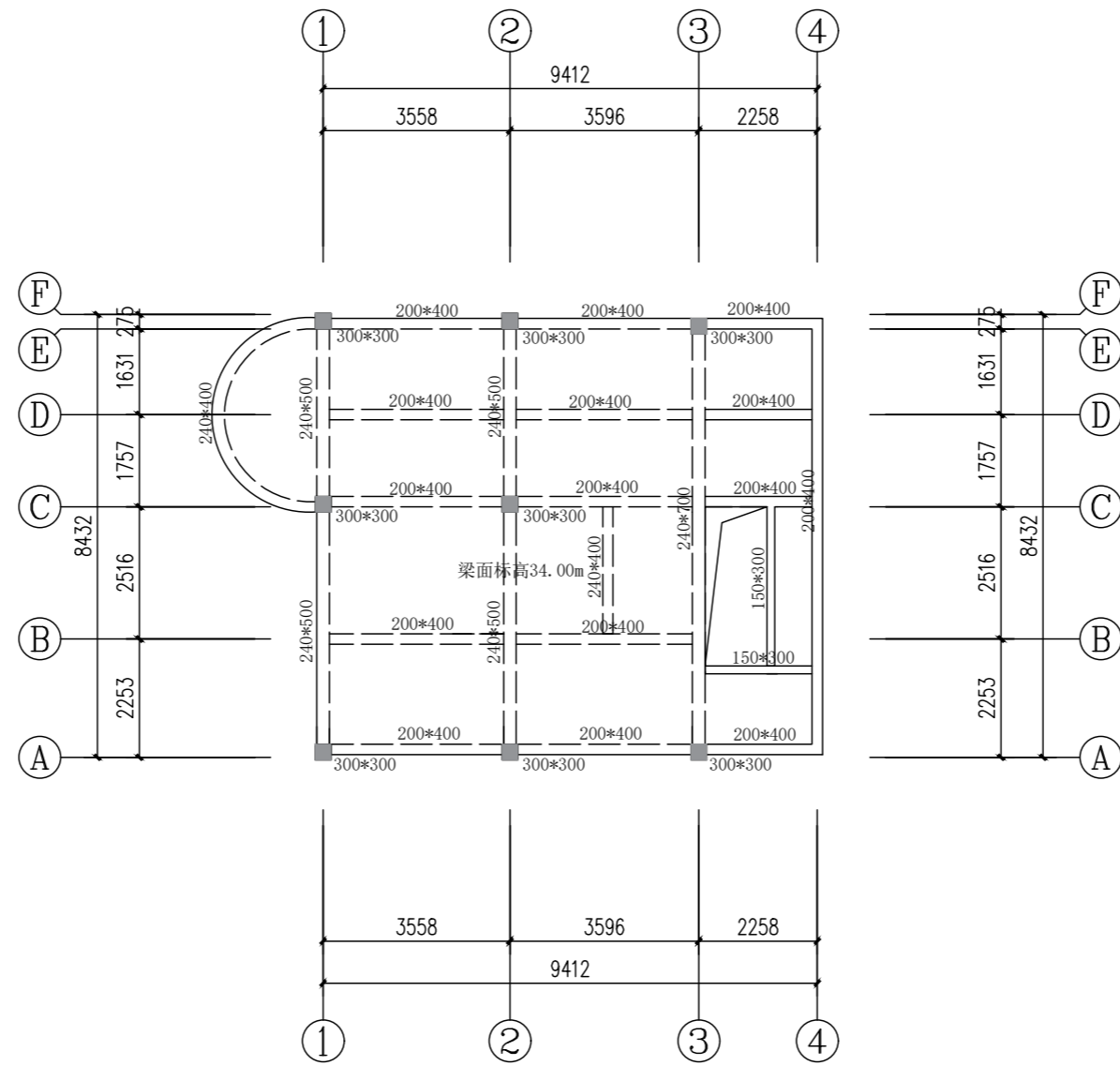

楼顶 (层高3.70m, 楼板厚0.10m)

